

TRACT	OWNER	DATE	ACRES	AMOUNT	REMARKS
1	Sylvester Housington & Wife	Idaho & Washington	7-24-07	20,299.74	14,192.00
2	Sylvester Housington & Wife	Idaho	7-24-07	20,299.74	14,192.00
3	Sylvester Housington & Wife	Idaho	7-24-07	20,299.74	14,192.00
4	F.A. Blackwell & Wife	Idaho	9-11-07	18,370.81	12,150.00
5	Mihills Land Co.	Idaho	7-14-07	18,100.00	17,150.00
6	F.A. Blackwell & Wife	Idaho	7-14-07	18,100.00	17,150.00
7	Mihills Land Co.	Idaho	7-14-07	18,100.00	17,150.00
8	Mihills Land Co.	Idaho	7-14-07	18,100.00	17,150.00
9	F.A. Blackwell & Wife	Idaho	7-14-07	18,100.00	17,150.00
10	F.A. Blackwell & Wife	Idaho	7-14-07	18,100.00	17,150.00
11	F.A. Blackwell & Wife	Idaho	7-14-07	18,100.00	17,150.00
12	F.A. Blackwell & Wife	Idaho	7-14-07	18,100.00	17,150.00
13	Spokane Lumber Co.	Idaho	1-26-09	15,470.00	23,100.00
14	Fidelity Lumber Co.	Idaho	1-26-09	15,470.00	23,100.00
15	P.H. Ho Chung, et al	Idaho	8-7-07	18,215.71	9,777.00
16	Spokane Lumber Co.	Idaho	7-12-06	20,383.64	25,180.00
17	Spokane Lumber Co.	Idaho	7-12-06	20,383.64	25,180.00
18	Spokane Lumber Co.	Idaho	7-12-06	20,383.64	25,180.00
19	F.A. Blackwell & Wife	Idaho	7-12-06	20,383.64	25,180.00
20	Midwick Lbr Co.	Idaho	7-12-06	20,383.64	25,180.00

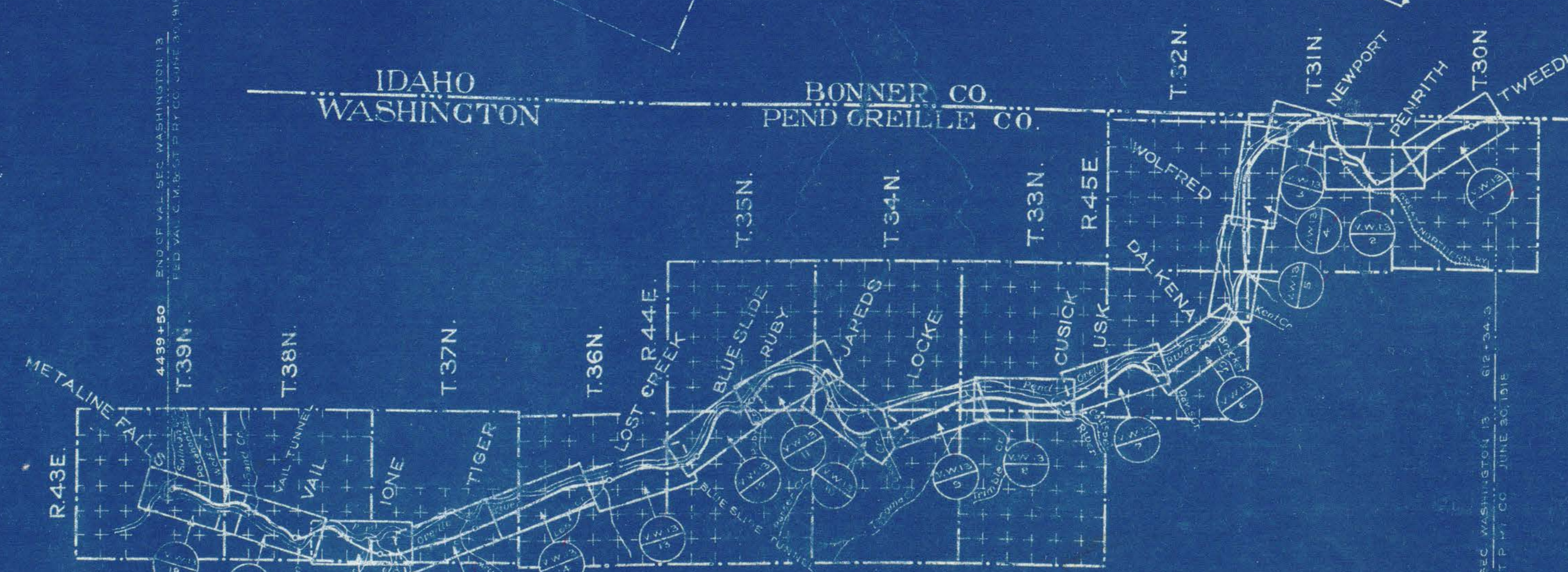

State of Illinois
County of Cook

I, the undersigned, officer of the Chicago, Milwaukee & St. Paul Railway Co., do hereby certify that this is a correct map, in a series of 16 (16) primary sheets and 17 (17) supplemental sheets of said railroad, from survey station 8152+37.5 to survey station 8430+50 prepared from the records of said company.

Chas. Lodge
Valuation Engineer

W.W.M. Spawny
Assistant to President

Subscribed and sworn to before me this 16 day of February, 1922
Frank M. Oakley
Notary Public in and for the County of Cook, State of Illinois.

My commission expires April 1, 1924.

RIGHT OF WAY AND TRACK MAP
CHICAGO, MILWAUKEE & ST. PAUL RY. CO.

OPERATED BY THE
CHICAGO, MILWAUKEE & ST. PAUL RY. CO.
IDAHO DIVISION
PEND OREILLE LINE
STATION 612+34.3 TO STATION 823+54.3

SCALE: 1" = 400 FT. JUNE 30, 1918
OFFICE OF VALUATION ENGINEER
CHICAGO, ILLINOIS.